

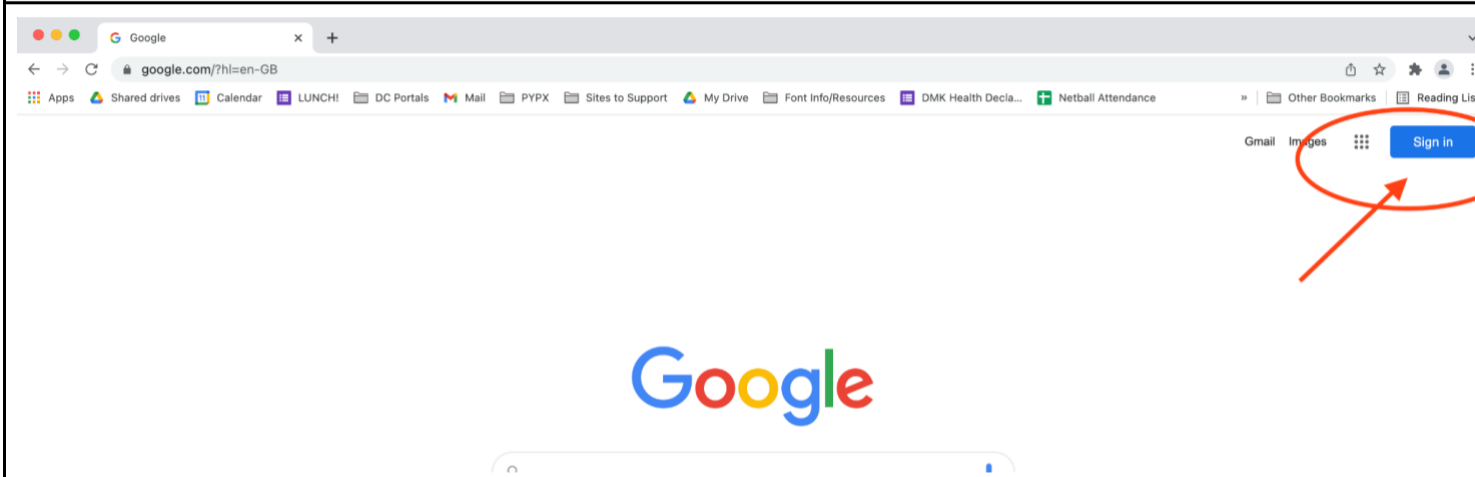

Laptop version

1. Using the student's Discovery College email address and password*, sign in to Google on your browser.



2. Open Zoom (zoom.us for desktop site or the app on your device)

3. When Zoom opens, click on the Google Sign in button. Leave username and password fields blank.

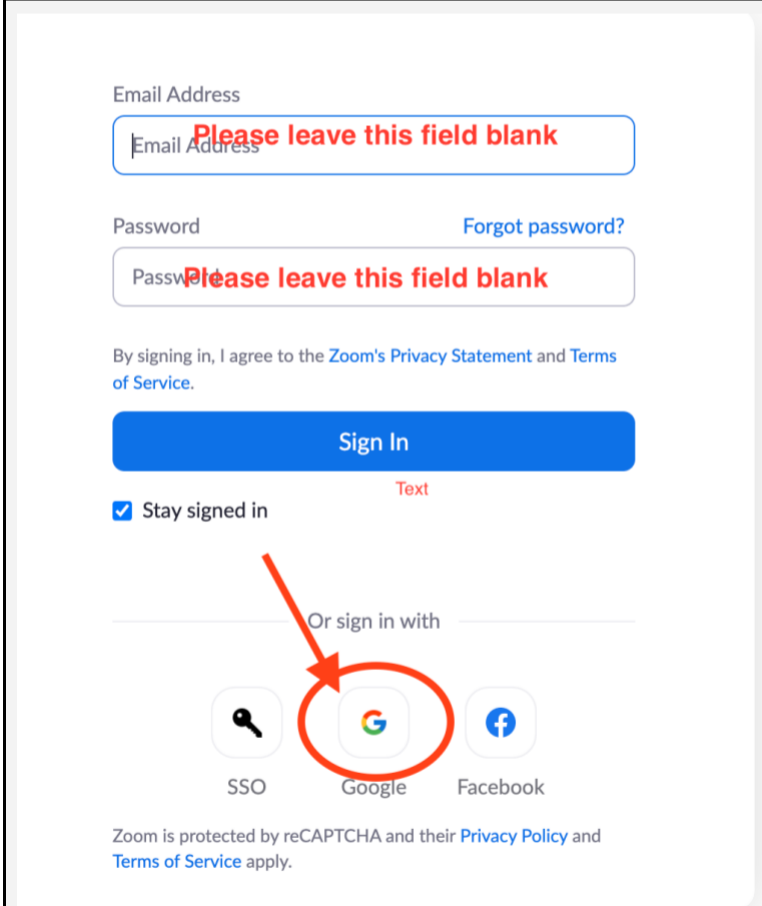

4. After signing in, use the classroom teacher's join link.

*for security and privacy, only Discovery College domain email addresses ([@dc.edu.hk](mailto:dc.edu.hk)) can be used in DC Zoom classes.



Tablet version

1. In the Zoom app, tap on the “Sign in” button

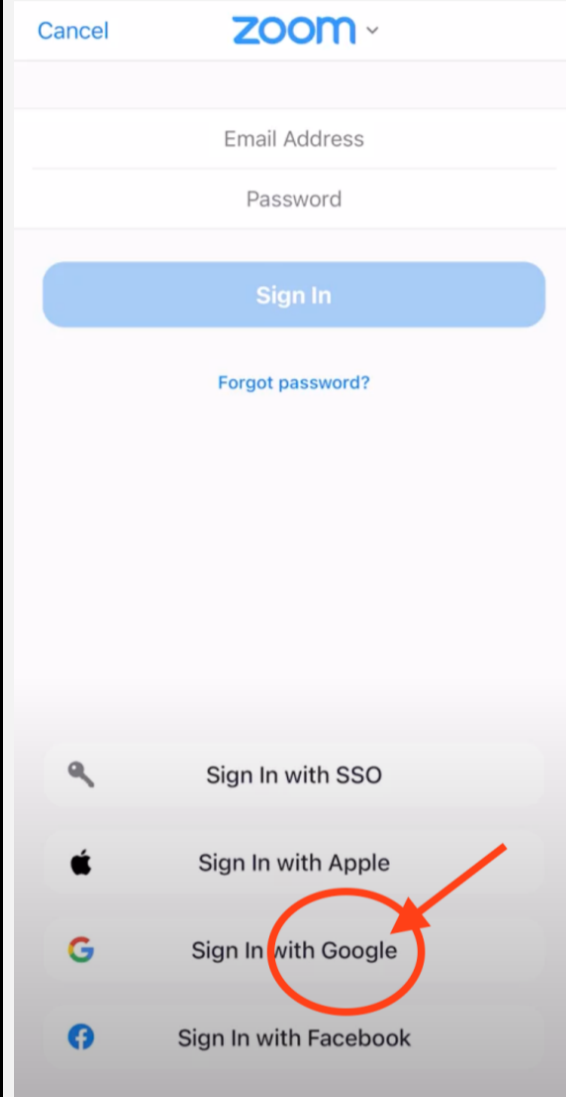

2. Tap on “Sign in with Google” button

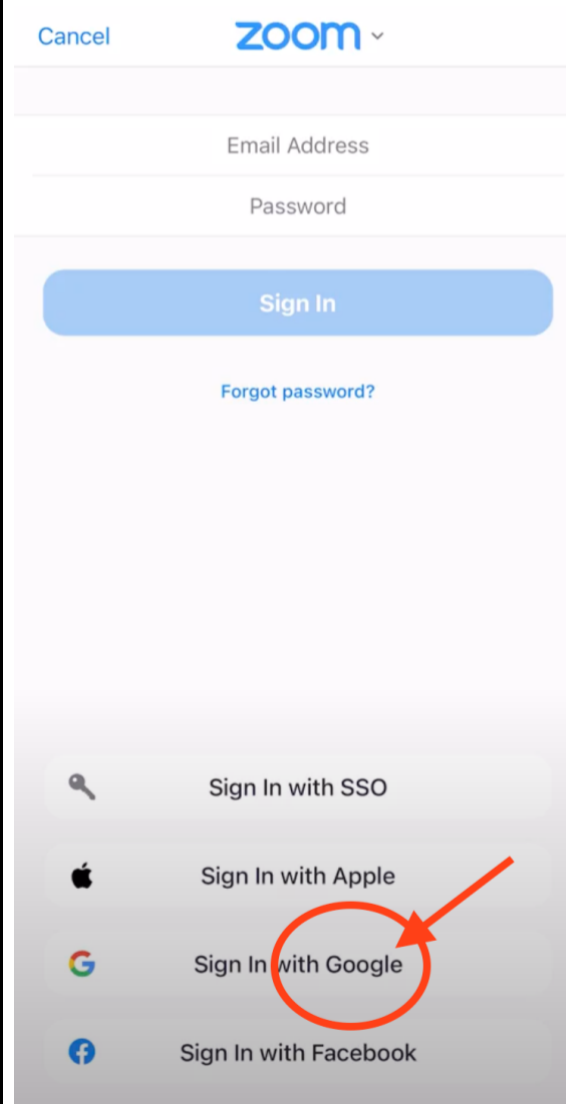

3. You may need to **“Use another account”** if you are logged on to Zoom using your personal account.

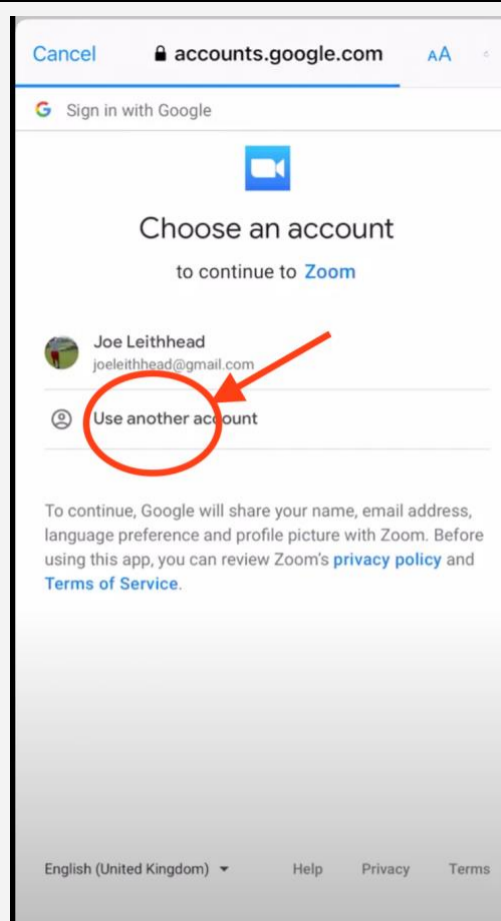

4. Sign in using your student's Discovery College email and password. For security and privacy, only Discovery College domain email addresses (**@dc.edu.hk**) can be used in DC Zoom classes.

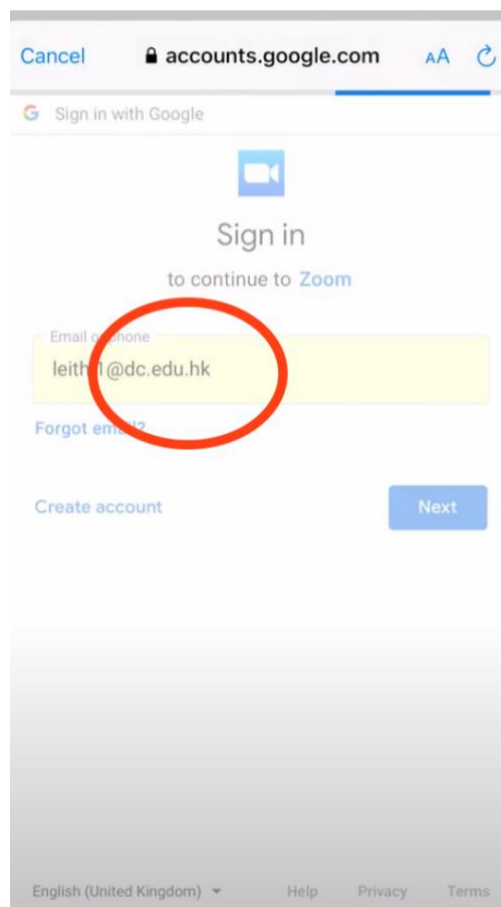

5. After signing in, use the classroom teacher's join link.